



FACULTY  
OF HUMANITIES  
Charles University





*Welcome to  
the Faculty of Humanities,  
Charles University in Prague!*

*As the youngest faculty of Charles University  
in Prague we offer a wide range of innovative  
study programmes in human sciences while  
putting a strong emphasis on multi-disciplinary  
research and perspectives in education.  
In cooperation with international partner  
institutions, we interconnect education,  
research and engagement in the public domain.*

*We hope that this brochure will provide you with  
useful information on our faculty.*

[www.fhs.cuni.cz](http://www.fhs.cuni.cz)  
[facebook.com/FHS.CU](https://facebook.com/FHS.CU)

# CONTENTS

■ Czech Republic	3
■ Charles University in Prague	5
■ Faculty of Humanities	7
■ Deans	9
■ Organisational structure	10
■ Education	11
■ Research	15
■ International cooperation	19
■ Facilities and services	21
■ Student life	23
■ Contacts	24





# CZECH REPUBLIC

The Czech Republic has far more to be proud of than its beer and ice hockey.

## Beautiful countryside and pleasant climate

The country is ringed by lovely mountain ranges (skiing thus being a favourite sport in winter months). At 1 602 meters above sea level, the peak of Sněžka is the highest point of elevation. Many important rivers - the Elbe, Oder, Morava, and Vltava - flow through the country (and so canoeing is popular in spring and summer). The climate is generally continental, with day temperatures in summer months usually well above 20 degrees Celsius.

## Crossroad of the East and the West

Thanks to its geographic location in Central Europe, the Czech Republic is often referred to as **the heart of Europe**. For over a thousand years, the historical lands of Bohemia, Moravia and Silesia have been crossroads of culture between the East and the West. The Czech Lands are a showcase of architectural styles, as reflected in many historic towns, castles and manor houses.

## Education with a tradition

The history of Czech education begins as early as in 863 with the coming of the Saints Cyril and Methodius, who served liturgy in the Slavonic language. **Higher education dates back to the 14th century**, when Charles University was established. Of multinational significance is John Amos Comenius, “the teacher of nations”, after whom the EU school partnership program Comenius takes its name.

### FACTS AND FIGURES

- Located in Central Europe
- History dates back to the 7<sup>th</sup> century
- Capital – Prague
- First president – Václav Havel
- Currency – Czech Crown
- EU member since 2004
- Population – 10,5 million inhabitants

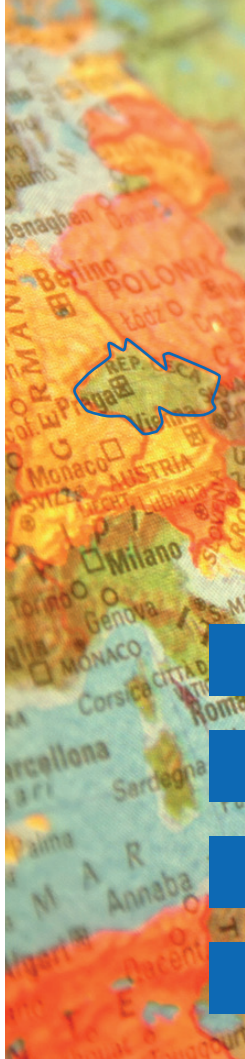



## Prague

Prague (“Praha” in Czech) is often referred to as **one of the most beautiful European capitals**. The capital and largest city of the Czech Republic has been a thriving cultural and political centre since the Middle Ages. “The city of a hundred spires” or “Golden Prague” is home to a unique collection of historical monuments built in various styles and dominated by Prague Castle. The historical city centre, set on both banks of the Vltava River, was inscribed in the **UNESCO World Cultural and Natural Heritage** register in 1992.

## Transportation

Prague has one of the best public transportation systems in Europe. Its location in the centre of Europe, also makes Prague a convenient point of departure for **trips to Vienna, Dresden, Budapest or Krakow**.

**i** Further information:

[www.myczechrepublic.com](http://www.myczechrepublic.com) / [www.czech.cz](http://www.czech.cz)

[www.praguewelcome.cz](http://www.praguewelcome.cz) / [www.praha.eu](http://www.praha.eu) / [www.dpp.cz](http://www.dpp.cz)



# CHARLES UNIVERSITY IN PRAGUE

Charles University (CU) was founded in 1348, making it one of the oldest universities in the world. Yet it is also renowned as a modern, dynamic, cosmopolitan and prestigious institution of higher education. It is the largest and most renowned Czech university, and is the best-rated Czech university according to international rankings.

The University currently comprises 17 faculties (14 in Prague, 2 in Hradec Králové and 1 in Plzeň), plus 3 institutes, 6 other centres of teaching, research, development and other creative activities, a centre providing information services, 5 facilities serving the whole University, and the Rectorate – which is the executive management body for the whole University. The number of University employees exceeds 7 900, of whom almost 4 500 are academic and research staff.

Charles University has over 53 000 students – roughly a sixth of all students in the Czech Republic – enrolled in more than 300 accredited degree programmes that offer over 642 different courses. The University has over 7 000 students from other countries. Every year, just under 9 000 students complete their studies; Charles University graduates enjoy one of **the highest employment rates of any population segment in the Czech Republic**. Every year a diverse range

of lifelong learning courses is attended by more than 16 000 participants.

The key priority of Charles University is to continue to enhance its prestigious status as a **research university**. The University is currently the best-performing research institution in the Czech Republic.

Charles University collaborates with a broad spectrum of renowned universities from all over the world, and one of its priorities is to enable all of its students interested in studying abroad to do so. International cooperation has also supported the University's efforts to achieve high standards of excellence in joint international research projects, its participation in many prestigious international organisations and university networks, and its active support for international student and academic staff mobility.





## RANKING

The Academic Ranking of World Universities – the “Shanghai League”, which every year compares more than 1 000 of the world’s best universities (selected from a total of over 17 000 institutions), has repeatedly included Charles University **among the top 2 percent of world universities** and one of the 100 best universities in Europe. Within the framework of the Erasmus programme, Charles University was the **7<sup>th</sup> most visited university in Europe** in the academic year 2013/2014.

## FACTS AND FIGURES

- 53 000 students
- 7 000 international students
- 4 500 academic and research staff
- 300 degree programmes
- 17 faculties

📍 Ovocný trh 3-5, 116 36, Prague 1 – Staré Město  
☎ +420 224 491 111, ✉ [uk@cuni.cz](mailto:uk@cuni.cz)  
📄 Further information: [www.cuni.cz/UK-1.html](http://www.cuni.cz/UK-1.html)





# FACULTY OF HUMANITIES

Originally founded as the Institute for Liberal Education of Charles University in 1994, the Faculty of Humanities (FHS), Charles University, gained full academic autonomy in 2000. It was established to provide study programmes in humanities, and in social and cultural anthropology, which was previously not available at the University, and to answer important transitional needs.

The Faculty is the youngest faculty of the University. Perhaps due to this it is a **modern and innovative institution** that has been reflecting the latest trends in university education since its foundation.

## MISSION

The mission of the Faculty of Humanities is through high-quality education to endow students with the ability to lead a fulfilling life in our increasingly complex and changing world.

## GOALS

- to provide education in humanities and social sciences that meets the highest international standards;
- to achieve excellence in research and integrate it with education;
- to promote the mobility of the FHS's increasingly international student body and academic staff;

- to cultivate the ability of students to learn throughout life and encourage self-responsibility and commitment to society.

The Faculty provides **higher education in humanities** and offers the bachelor's study programme *Liberal Arts and Humanities* (also in English), 10 master's study programmes (2 in English, 1 in German and 1 in French) and 8 doctoral study programmes (6 in English, 2 in French and 1 in German).

Professionally, the Faculty focuses on a wide range of **human sciences**. At Charles University it acts as an interdisciplinary connector of philosophy, social sciences and humanities on the one side, and natural and medical sciences on the other. It carries out research in the fields of philosophy, social sciences and humanities, implementing and supporting projects of basic and applied research in these disciplines.





The Faculty is involved in a range of research projects which enjoy international participation. It participated in several projects of the 6<sup>th</sup> and 7<sup>th</sup> EU Framework Programmes, the CEEPUS projects and other international and national organisations.

In line with its long-term plan, the Faculty puts strong emphasis on the close connection between research, international relations and education.

Support is given to the internationalisation of the Faculty's studies and to **international cooperation** in research activities. It has closed more than 80 contracts with partner institutions from around the world relating to exchanges of students and teachers. In a consortium with leading German and French universities it implements a joint program of *German and French Philosophy*.

In addition, through its work with the non-academic sector, it further cements the position of the University as one of the **leading institutions in the public domain**.

## FACTS AND FIGURES

- 2 400 students
- 200 academic staff
- 40 administrative staff
- 3 research centres
- 3 institutes
- 24 departments

## FHS IN A NUTSHELL

- Charles University's youngest faculty
- State funded institution
- Liberal form of study
- Strong emphasis on multi-disciplinary research
- Internationally oriented
- Engaging with the public domain
- Wide range of study programmes in English, French and German
- Support of student's self-responsibility
- Supportive to distance learning and e-learning

# DEANS



## Prof. PhDr. Jan Sokol, CSc., Ph.D.

is a Czech philosopher, translator of philosophical texts, university teacher and publicist. He is a significant contemporary Czech Christian intellectual. His main area of interest is that of phenomenology, philosophic anthropology, ethics, religious science, anthropology of law and anthropology of institutions. He lectures at Czech and foreign universities, especially on philosophical and European topics. From 1990 to 1992 he was a Deputy of the Federal Assembly, in 1998 he was Minister of Education, and in 2003 he was a nominated candidate for the Presidency of the Czech Republic. From 2000 to 2007 he was the first Dean of the Faculty of Humanities where he works until today.

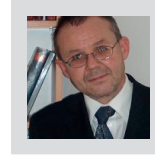

## Doc. PhDr. Ladislav Benyovszky, CSc.

is a Czech philosopher, translator and university teacher. His domain covers ontologically oriented philosophies and phenomenologies of mostly German authors; he is a renowned expert on the philosophies of Fichte, Hegel, Kierkegaard, Husserl and Heidegger. Apart from the issue of being and time, he follows and expands on the philosophic thematisation of human existence, speech and mortality. His contribution has been essential to the creation of the new concept of philosophical anthropology at the Faculty, of which he is the current Dean.





# ORGANISATIONAL STRUCTURE

The FHS is managed by the Dean and the Dean's Collegium. Autonomous academic authorities of the Faculty are as follows.

Dean

Academic  
Senate

Scientific  
Committee

Disciplinary  
Committee

Faculty  
Secretary

The core of the Faculty is formed by three institutes, each of which comprises several departments providing education at the given level and in a given programme or discipline.

## ■ Bachelor Study Degree Programme

Department of Arts  
Department of History  
Department of Languages  
Department of Philosophy  
Department of Qualified Skills  
Department of Social Studies

## ■ Master Study Degree Programmes

Civil Sector Studies  
European Cultural and Intellectual History  
Gender Studies  
General Anthropology  
German and French Philosophy  
Historical Sociology  
Management and Supervision  
in Social and Health Care Organisations  
Oral History – Contemporary History  
Social and Cultural Ecology

## ■ PhD Study Degree Programmes

Anthropology  
Applied Ethics  
Civil Sector Studies  
Environmental Studies  
General Anthropology  
German and French Philosophy  
Historical Sociology  
Semiotics and Philosophy of  
Communication

The **administrative matters** of the Faculty are managed by the offices within the Deanery. The head of the Deanery is the Secretary of the Faculty. **i** Further information: [fhs.cuni.cz/FHSENG-383.html](https://fhs.cuni.cz/FHSENG-383.html)

# EDUCATION

The Faculty offers the bachelor's study programme *Liberal Arts and Humanities*, 10 master's study programmes (2 are run in English, 1 in German and 1 in French) and 8 doctoral study programmes (6 are run in English, 2 in French and 1 in German).

*FHS fully implemented the European Credit Transfer and Accumulation System (ECTS) – a workload-based system for measuring and comparing study results – thus allowing simple and transparent interpretation of the level of academic performance as well as full recognition of studies at any European higher education institution.*

## Bachelor's degree programme

The **three-year bachelor's degree programme** in *Liberal Arts and Humanities* is a **multidisciplinary programme** which equips students with a **strong background in humanities and social sciences**. In addition to studying a wide range of disciplines (philosophy, history, sociology, psychology, economics, anthropology, languages), students focus on a subject of their choice. Such broad-based university education is common in North America and Anglo-Saxon countries, but **unique in the Czech Republic**.

## WHY STUDY LIBERAL ARTS AND HUMANITIES?

- An ideal preparation for further post-bachelor studies in humanities and social sciences.
- A liberal form of study, i.e. an open study curriculum with only a few compulsory courses.

## Master's degree programmes

A variety of follow-on master's programmes can be studied at FHS. The regular duration of the programmes is **two years**. The selective international **Erasmus Mundus** programme is offered by the international consortium of universities and funded by the European Union.

## Doctoral degree programmes

FHS offers a wide range of three-year highly competitive doctoral programmes. **Cotutelle** (joint supervision of dissertations by two tutors; one from FHS and one from a foreign university) is available to outstanding doctoral students.





*"I have learnt to research facts and information on my own and to think about things from different perspectives. And everyone is really professional and friendly."*

**3<sup>rd</sup> year student of Liberal Arts and Humanities**

### Study offered in foreign languages

The Faculty of Humanities offers many opportunities to study in foreign languages. **Most of the study programmes are taught in English** (unless otherwise specified) but there are also programmes taught in **German and French**.

#### ■ Bachelor's degree study programme

Liberal Arts and Humanities

#### ■ Master's degree study programmes

German and French Philosophy (taught in German)

Historical Sociology

Master Erasmus Mundus EuroPhilosophie (taught in French and German)

Oral History – Contemporary History

#### ■ Doctoral study programmes

Anthropology

Applied Ethics

Civil Sector Studies

Environmental Studies

General Anthropology

German and French Philosophy (taught in French and German)

Historical Sociology

Semiotics and Philosophy of Communication (taught in French)



## Lifelong learning

Lifelong learning is an important part of the educational activities of the Faculty of Humanities. FHS offers courses aimed at various target groups: applicants, graduates and seniors, as well as students and any others who are interested.

### FHS STUDENTS ENJOY...

- An open study curriculum
- Partnership relationship with teaching staff
- A wide range of courses in English
- Many opportunities to study abroad
- Guest lectures by international experts
- Helpful administrative staff
- Well-stocked library
- A wide selection of postgraduate studies

### TUITION FEES

- Programmes in English: 2 000 EUR / year
- German and French Philosophy: 350 EUR / year

### FACTS AND FIGURES

- 2 400 students
- 250 international students
- 18 degree programmes
- 8 degree programmes in English

### ACADEMIC CALENDAR

#### Winter semester

- Teaching period: end of September to early January
- Exam period: January to mid-February

#### Summer semester

- Teaching period: mid-February to mid-May
- Exam period: mid-May to end of June, early September to mid-September

A introductory **summer school** for new degree students is held prior to the start of the academic year.

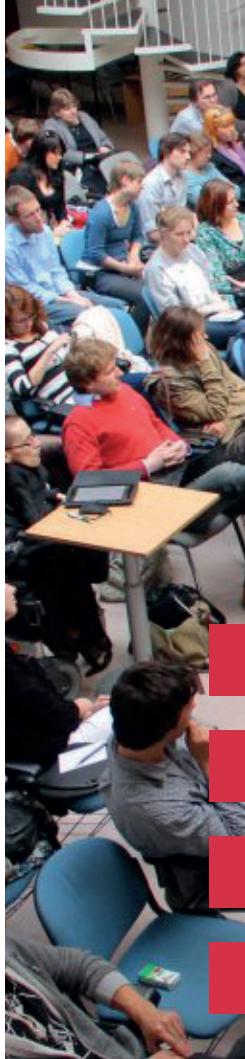



## APPLICATION PROCEDURE

The **entrance exam** usually consists of a language test and a written test on designated literature. The form of the entrance exam may differ depending on the particular programme.

For detailed information consult the relevant programme website at [fhs.cuni.cz/FHSENG-314.html](https://fhs.cuni.cz/FHSENG-314.html).

**Requirements:** recognised foreign academic qualifications; for some programmes also a motivation letter and CV

**Exam date:** June

## APPLICATION DEADLINES

- February 28 (BA and MA studies)
- April 30 (PhD studies)

 Further information: [fhs.cuni.cz/FHSENG-321.html](https://fhs.cuni.cz/FHSENG-321.html)



# RESEARCH

FHS's institutional priorities include the development of high-level research and its integration in education.

FHS research is interdisciplinary by nature as the Faculty is involved in a range of national and international research projects. Research activities at the Faculty of Humanities are managed by the Department of Science and Research, while scientific monographs, the fundamental outputs of research and scientific activities, are issued by the Publications Office.

## Formulating research strategies

The Faculty of Humanities formulates its central strategies of academic research by evaluating the processes of specialisations in basic research. The **chief research** fields have proved to be phenomenology and semiotics; cultural, social and historical anthropology; interdisciplinary social sciences and environmental studies.

## Examples of international research projects

- Religious Cultures in 19<sup>th</sup> and 20<sup>th</sup> century Europe

(in cooperation with Ludwig Maximilian University of Munich)

- Men and Books. From Micro-organisms to Mega-organisms (in cooperation with University of Natural Resources and Life Sciences in Vienna)
- Societal Engagement in Science, Mutual learning in Cities (under the EU's 7<sup>th</sup> Framework Programme)
- Novel policy framework for active, healthy and dignified ageing and the provision of health and long term care services

## Associate professorships and full professorships

The FHS is the only faculty of Charles University accredited with the appointment procedure (habilitation) for associate professorships (the degree “docent”) and for full professorship (the degree “professor”) in “Social and Cultural Anthropology”.





### Doctoral studies

The Faculty of Humanities offers eight doctoral study programmes. Students are provided with all the support they need to develop excellent research skills. Students' research focuses on anthropology, philosophy and social sciences in interdisciplinary perspective and is financed by the Charles University Grant Agency and by the Specific Academic Research Projects Competition. Doctoral students regularly participate in national and international conferences.

### Post-doc researchers

As part of the Faculty's on-going endeavour to maintain, develop and strengthen its research base, the Faculty of Humanities is keen to recruit high-quality post-doctoral research fellows from abroad.

## CHARACTERISTICS OF FHS RESEARCH

- Focus on a multi-disciplinary approach
- A strong record in fundamental and applied research
- Valued contribution to international academic discourse
- Top quality publications
- Integration in education
- High societal relevance





## Research centres

### Centre of Expertise in Longevity and Long-term Care

The centre focuses on the analysis of longevity and ageing related issues with emphasis on the application of research results in public policies, and in the management and delivery of public or private services.

**i** Further information: [www.cello-ilc.cz](http://www.cello-ilc.cz)

### Civic Education Centre

The core mission of the centre is to encourage citizens to develop the skills necessary for improved navigation in the public domain and for effective participation in public life.

**i** Further information: [www.obcanskevzdelavani.cz](http://www.obcanskevzdelavani.cz)

### Phenomenology Research Centre

This excellent centre focuses both on the traditional aspects of modern philosophy, and those crossing the borders of philosophy to sociology, political philosophy, aesthetics, literary science, history of science, and logic.

**i** Further information: [www.fenomenologie.eu](http://www.fenomenologie.eu)

## CORE RESEARCH AREAS

Philosophy of art ■ Phenomenology ■ Hermeneutics ■ Philosophical anthropology ■ Ethics ■ Semiotics ■ Theory of communication ■ Visual studies ■ Performance studies ■ Urban anthropology ■ Religion studies ■ History of intellect ■ Gender studies ■ Behavioural-evolutionary sciences ■ Social history ■ History of mentalities ■ Cultural history ■ Historical anthropology ■ Historical demographics ■ Oral history ■ Historical sociology ■ Gerontology ■ Studies of cognitive defects ■ Multicultural education ■ Social economy ■ Ecology ■ General anthropology...

## FACTS AND FIGURES

- 14 fundamental research projects
- 3 scientific journals
- 60 issued publications
- 8 doctoral programmes
- 29 associate professors
- 20 full professors



An open book with aged, yellowed pages and a dark cover, positioned on the left side of the page.

## Publications

The Faculty issues publications mainly as fundamental outputs of research and scientific activities. Articles, monographs and textbooks are published directly by the Faculty or by its partner publishing houses (Karolinum, Togga, and others). Many recent titles are available online (under the Creative commons BY-NC-ND licence). Publications have mostly been in Czech, but some are now also in English and German.

### SCIENTIFIC JOURNALS

- Urban People
- History – Theory – Criticism
- Historical Sociology

 Further information:

[fhs.cuni.cz/FHSENG-367.html](https://fhs.cuni.cz/FHSENG-367.html) / [fhs.cuni.cz/FHSENG-414.html](https://fhs.cuni.cz/FHSENG-414.html)

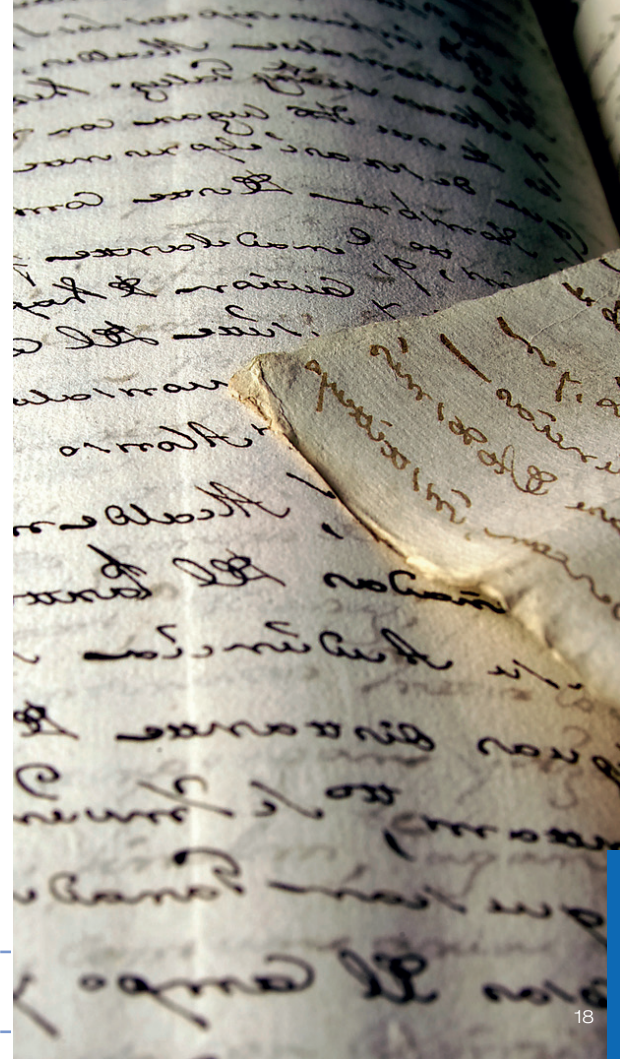

# INTERNATIONAL COOPERATION

The Faculty is highly supportive of student and academic staff mobility and encourages their participation in various types of programmes (Erasmus+, CEEPUS, AKTION, the Visegrad fund, inter-governmental agreements, and bilateral agreements at either Faculty or University level), thus promoting an international and multicultural environment in classes, where Czech and international students from all over the world can study together.

A wide range of the Faculty's courses in English (German, French, etc.) are recognised within various programmes designed in cooperation with partner institutions:

- The Erasmus Mundus programme *German and French Philosophy in the European Context (EuroPhilosophie)* offers highly qualified students from around the world a joint Master's study course in the field of philosophy.
- The one-semester *Undergraduate Programme in Central European Studies* (UPCES), managed in cooperation with CERGE-EI, is open to

students from top-tier American universities and FHS students. Courses within the programmes *Central European Studies in Prague* and *Jewish Studies in Prague* are held in cooperation with CET Academic Programs.

The number of international students studying at the FHS is increasing steadily. They have three options for studying at the FHS: as degree-seeking students, as **exchange students**, or as students from a non-partner university (so-called visiting students or free-movers)

*"Studying abroad in the Czech Republic has opened my eyes to the culture and history of Central Europe."*  
exchange student

Counselling and overall support to incoming and outgoing students and staff is provided by the **International Office**. The office also manages a group of student tutors: volunteers who provide the incoming students with assistance concerning the practical issues of their stay and introduce them to life in Prague.

### FACTS AND FIGURES

- 250 incoming students / year
- 100 outgoing students / year
- 200+ courses in English, German or French
- 60 Erasmus+ partner universities
- 40 Inter-university and faculty bilateral agreements

**i** Further information:

[fhs.cuni.cz/FHSENG-349.html](https://fhs.cuni.cz/FHSENG-349.html) (application procedure and deadlines for exchange and visiting international students)

[fhs.cuni.cz/FHSENG-350.html](https://fhs.cuni.cz/FHSENG-350.html) (course catalogue)





# FACILITIES AND SERVICES

Our Faculty aids student life by providing many services with no additional charge (internet access, library, counselling, etc.) or for subsidised prices (accommodation, catering).

## Accommodation

Accommodation is provided in Charles University's halls of residence (dormitories). **Students** are usually housed in double-occupancy rooms.

**Visiting teachers** generally stay at the University's hotels in Celetná Street (city centre) or in Jinonice (FHS headquarters).

## Cafeterias

Charles University operates a number of cafeterias ("menzas") at different Prague locations. The FHS cafeteria is located on the ground floor of the main building in Jinonice. Cafeterias offer some meals for students (incl. international) and employees (incl. visiting) at a discount price.

## IT facilities

PC workstations are available in the computer labs in various University buildings. Wireless Internet can be accessed inside the University buildings. IT services are without charge.

## University Card

Charles University Cards serve as evidence of the holder's relation to Charles University and as a universal "key" to a variety of services, saving time and making life easier. The CU Card allows you to:

- use it as a travel pass for Prague public transport if you are 25 or younger;
- log in to the Student Information System (SIS);
- access the Jinonice and other CU facilities (internet, computer labs, library, copying, etc.);
- order lunch in any CU cafeteria.

CU Cards are issued in the CU Information and Advisory Centre.

## CU Information and Advisory Centre

The centre offers free help and advice to students, people interested in studying at the University, graduates, staff, and visitors to Charles University. Students and staff are provided with





career advice, assistance with social and legal issues, and with coaching or psychological and professional counselling. The Centre has several branches. Its headquarters is in central Prague, in Celetná Street.

### Sports facilities

Sports facilities are located in the Hostivař campus (Bruslařská 1132, Prague 15) and provide a wide range of activities from fencing to canoeing.

### Library

The Charles University library system is de-centralised and comprises a number of libraries at different locations. The **FHS's Masaryk Library of Social Sciences** is located on the ground floor of the main building in Jinonice. It is usually open all work days, including Saturdays during the exam period. The university collection has over 80 thousand volumes, and acquires about 4 thousand new titles each year. An electronic database supplements the printed documents, giving access to thousands of e-magazines and more than 100 thousand e-books. After registering, students and faculty staff may also have home access to these electronic resources.

**i** Further information: [knihovna.jinonice.cuni.cz](http://knihovna.jinonice.cuni.cz)

### Student scholarships

Students can be awarded several types of scholarships:

- special-purpose scholarships (including Erasmus+ scholarships);
- scholarships awarding a student's academic excellence;
- accommodation grants;
- welfare benefits in cases of severe social hardship, or other emergency conditions.

### Students with special needs

At Charles University, students with special needs can use a range of services which are designed to help them overcome any difficulties they may encounter. Support is provided chiefly by the CU Information and Advisory Centre, and by individuals working together to help students overcome obstacles caused by their special needs.

### Recreation

Our teachers and students may enjoy the recreation facilities of Charles University located in several beautiful regions of the Czech Republic. The facilities are designed for summer schools of CU students and for the recreation of CU staff.

# STUDENT LIFE

What makes studying at FHS even more fulfilling is participation in student associations and clubs. Students are free to choose from all sorts of options from a movie club to a wide range of sports, music and other creative activities, and may even apply for financial support of their leisure activities. If thus pursued, the ensuing requirement to communicate and structure their projects within their studies, offers students great scope for developing their soft skills.

## Student associations and clubs

- FHS UK Students Association
- Film club
- Charles University Chorus and Orchestra
- Charles University International Club (IC CUNI)
- Facebook group International Students, Faculty of Humanities, CU in Prague
- Freshman Facebook group
- Alumni association on LinkedIn
- Humr – online student magazine

## FHS UK Students Association

This association encourages the development of projects and other activities initiated by students. Balls, music festivals, meetings of students and teachers, travel discussions and trips are organised under its auspices and it runs an e-shop with promotional merchandise. *Contact:* [studenti.fhs@email.cz](mailto:studenti.fhs@email.cz)

Each year the Faculty arranges student trips to culturally and historically significant places of Europe, and offers students fieldwork in subjects such as ethnology, archaeology and ecology. Twice yearly an academic and cultural orientation for new international students is organised by the International Office. International students enrolled in the courses of the UPCES programme have opportunities to join trips out of Prague and the Czech Republic.

**i** Further information: [fhs.cuni.cz/FHSENG-382.html](https://fhs.cuni.cz/FHSENG-382.html)



# CONTACTS

## Institute of Master Degree Study Programmes

Electronic Culture and Semiotics:

[i eks.fhs.cuni.cz](mailto:eks.fhs.cuni.cz)

Gender Studies:

[i www.gender.fhs.cuni.cz](http://www.gender.fhs.cuni.cz)

General Anthropology:

[i www.fhs.cuni.cz/antropologie](http://www.fhs.cuni.cz/antropologie)

Management and Supervision in Social  
and Health Care Organisations:

[i krs.fhs.cuni.cz](mailto:krs.fhs.cuni.cz)

Social and Cultural Ecology:

[i www.kske.cz](http://www.kske.cz)

Civil Sector Studies:

[i ksos.fhs.cuni.cz](mailto:ksos.fhs.cuni.cz)

Historical Sociology:

[i hiso.fhs.cuni.cz](mailto:hiso.fhs.cuni.cz)

Oral History – Contemporary History:

[i www.fhs.cuni.cz/OHSD](http://www.fhs.cuni.cz/OHSD)

German and French Philosophy:

[i filosofie.fhs.cuni.cz](mailto:filosofie.fhs.cuni.cz)

European Cultural and Intellectual History:

[i ekdd.fhs.cuni.cz](mailto:ekdd.fhs.cuni.cz)

## Offices of the Deanery

The Dean's Office:

[@ deansoffice@fhs.cuni.cz](mailto:deansoffice@fhs.cuni.cz); [☎ +420 251 080 212](tel:+420251080212)

Students' Administration Office:

[@ study@fhs.cuni.cz](mailto:study@fhs.cuni.cz); [☎ +420 251 080 211](tel:+420251080211)

PhD Study Administration Office:

[@ phd@fhs.cuni.cz](mailto:phd@fhs.cuni.cz); [☎ +420 251 080 351](tel:+420251080351)

The Department of Science and Research:

[@ research@fhs.cuni.cz](mailto:research@fhs.cuni.cz); [☎ +420 251 080 403](tel:+420251080403)

Publications Office:

[@ marie.kratochvilova@fhs.cuni.cz](mailto:marie.kratochvilova@fhs.cuni.cz); [☎ +420 251 080 390](tel:+420251080390)

International Office:

[@ international@fhs.cuni.cz](mailto:international@fhs.cuni.cz); [☎ +420 251 080 334](tel:+420251080334)

External Affairs Office:

[@ pr@fhs.cuni.cz](mailto:pr@fhs.cuni.cz); [☎ +420 251 080 212](tel:+420251080212)

Students with special needs:

[@ eliska.pincova@fhs.cuni.cz](mailto:eliska.pincova@fhs.cuni.cz)

## Internet links

[f Facebook: FHS.CU](#)

[in LinkedIn: Faculty of Humanities CU - Alumni](#)

[🐦 Twitter: FHS.CU](#)

[📺 YouTube: Studijní oddělení FHS UK](#)





# CONTACTS

## University site Jinonice

The headquarters of the Faculty is located in a new, award-winning campus-like facility of Charles University in the Prague district of Jinonice. The buildings have **barrier-free access** and house the Institute of Liberal Arts and Humanities, the Department of Historical Sociology, the Department of Social and Cultural Ecology, the Department of European Cultural and Intellectual History, the Department of German and French Philosophy, the Institute of PhD Study Programmes and the Deanery (administrative offices). Cafeteria, buffet, computer labs, library and study room are also available.

📍 U Kříže 8, 158 00 Prague 5 – Jinonice, ☎ +420 251 080 212

🚶 **Public transport:** metro line B (station *Jinonice*), buses No. 137, 176 (stop *Jinonice*)



## University site Vokovice – Veleslavín

This site houses the Institute of **Master Degree Study Programmes**, the Department of Electronic Culture and Semiotics, the Department of Gender Studies, the Department of General Anthropology, the Department of Civil Sector Studies and the Department of Oral History – Contemporary History. Cafeteria, buffet, library and study room are also available.

📍 José Martího 31, 162 52 Prague 6 – Veleslavín, ☎ +420 220 172 434

🚶 **Public transport:** trams No. 2, 20, 26, 51 (stop *Nad Džbánem* or *Vozovna Vokovice*)



## Máchova street

The training centre called Marianeum houses the Department of Management and Supervision in Social and Health Care Organisations.

📍 Máchova 7, 120 00 Prague 2 – Vinohrady, ☎ +420 221 592 544

**i** Public transport: metro line A (station *Náměstí Míru*), bus No. 135, trams No. 4, 22, 57, 59 (stop *Jana Masaryka*)



## The University Site in Troja

The Faculty of Humanities is to move to a University area in Trója, where all departments, offices and facilities will all be situated together. The architectonic layout of the new building is by Kuba & Pilar atelier. In June 2014, the investment plan was registered and grant approved. Student dormitories and the Faculty of Mathematics and Physics, Charles University are situated nearby.

📍 Pátkova 3, 180 00 Prague 8 – Trója

**i** Public transport: metro line C (station *Holešovice*)

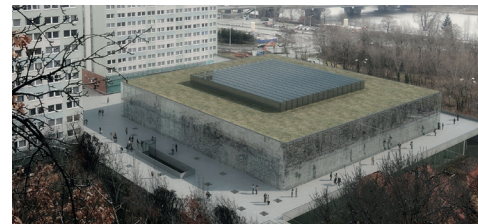

### 📍 Map: University site Jinonice

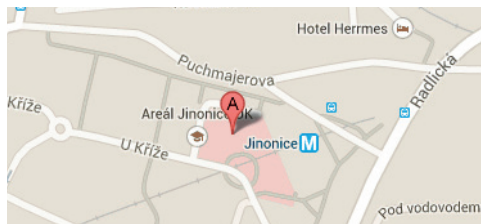

### 📍 Map: University site Vokovice – Veleslavin



### 📍 Map: Máchova street

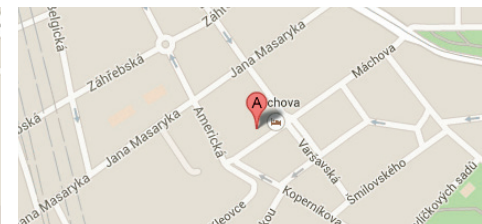



Editors Katsiaryna Tourková, Magdaléna Hromková  
Language editor Clare Wille  
Photos by Vladimír Šigut  
CU photos by [www.IForum.cuni.cz](http://www.IForum.cuni.cz)  
Graphic design by David Pála  
Printed by Reklama Straka  
Available for free.

First edition  
Prague 2014

